

AVALANCHE

Downhill Racing



MONTIE

Monotube

**2.25 to 3.0" STROKE DOWNHILL
MOUNTAIN BIKE SHOCK**

AVALANCHE

Downhill Racing

Avalanche Monotube shocks have rebound damping to allow you to fine tune your suspension for the increasing demands of today's downhill terrains. The shock is charged with a nitrogen and has adequate oil and N2 volume so you will not experience shock fade during a run. The shock features hard coat anodized aluminum CNC machined 30mm inside diameter body and a 12.5 mm diameter hard chrome steel shock shaft. The shock shaft is guided by low friction teflon coated bushings and a 5mm wide teflon piston ring keeping stiction to a minimum - while maintaining the necessary stiffness for the most demanding riders. The seals are high quality double wiper-type with a separate dust seal. This means you won't have to replace seals and bushings every week to get ready for the race. The shock has a heavy duty bumper and a hydraulic anti-bottoming system to provide a soft cushion at the end of travel for those really big hits! The stainless steel shock bushings are provided with DU® sleeve bearings and dust seals for long life and reduced friction. The shock can also be revalved to suit the exact needs of your downhill riding style and ability.

MONTIE

Technical data

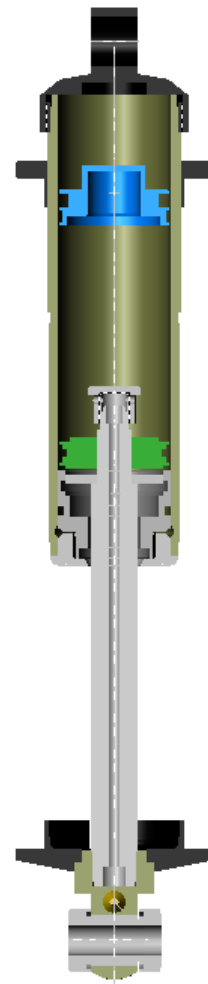

Montie 9.5 x 3.0

SPECIFICATIONS

SIZE.....	30mm dia
TRAVEL.....	2.25 to 3.0"
ADJUSTMENTS.....	16 clicks rebound threaded spring preload adjustment with lock nut
MATERIAL.....	lightweight anodized 6061 T6 aluminum, hard chrome steel shaft
WEIGHT.....	2lbs 1 oz for 3.0 stroke
SPRING.....	350-800 lb/in coil
SEALS.....	double lip rubber with separate dust scraper
BEARINGS.....	DU® on Cres Bushings
EYE.....	7/16" dia x .500" wide
SHAFT BUMPER.....	19 mm heavy duty bumper
OIL.....	MX Shock Fluid
NITROGEN.....	160-285 psi, not adjustable
VALVING.....	fully revalvable
OPTIONS.....	alternate spring rates, Ti springs
TOOLS.....	12.5mm shaft clamp, nitrogen charging gauges and charging needle



Technical data

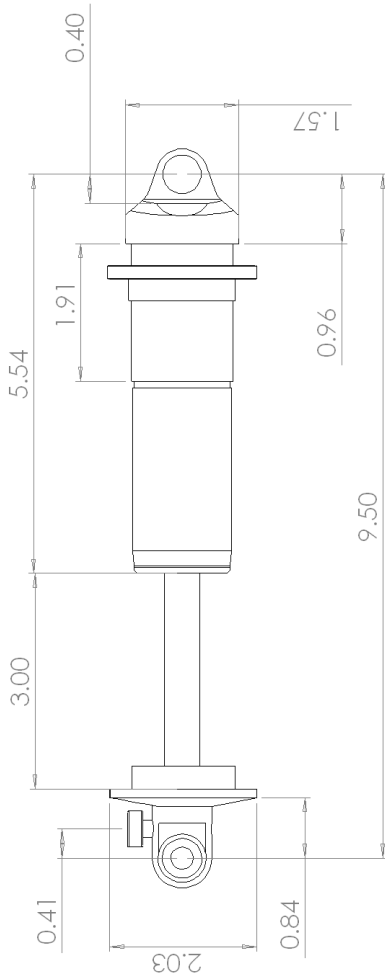

Montie 9.5 x 3.0

Set-up

The shock has an adjustable rebound. The rebound adjuster is at the bottom of the shock. The standard setting is 8 clicks out (counter clockwise) from full hard. To increase rebound damping turn the adjuster in (clockwise), this will slow the extension of the shock. To decrease rebound damping turn the adjuster out (counter clockwise) this will quicken the extension of the shock. Spring preload can also be changed to tune the shock to the weight of the rider. The shock spring preload can be varied by tightening or loosening the preload collars. The standard preload is 1.5 turns, (min 1 turn / max 3 turns). The rider sag must be adjusted to 1/3 of the total stroke with the rider sitting on the bike. This is the difference from fully extended position to the rider sitting. The ride height can be raised or lowered ± 5 mm to quicken or slow steering within the range of preload settings.

Add-on Features

The optional springs available are : 350 x 3.0, 450 x 3, 400 x 2.25, 500 x 2.25, 450 x 2.50, 550 x 2.75, 550 x 3.0, 600 x 2.25, 600 x 3.0, 650 x 2.75(Ti only), 700 x 2.25, 800 x 2.25 lb/in(Ti only).

The features and quality contained in this shock were previously only found in an off road motorcycle suspension - but have been adapted to a mountain bike to give you the edge and reliability required for the increased speeds and jumps encountered on today's downhill runs. Experience the future in downhill mountain biking.

Maintenance

The oil must be changed and nitrogen recharged every 60 hours or every 6 months whichever comes first.

Its all downhill from here!



WARRANTY

The set-up supplied with the shock has been adjusted for the rider weight, ability and terrain. The service, valving and set-up can be altered by Avalanche at the owners request within 60 days after the purchase date, free of charge. The shock is warranted for 1 year from date of purchase from defects and workmanship and will be repaired as required, free of charge. This warranty does not include damage caused by accident, wear and tear or abuse as determined by inspection by Avalanche. Avalanche shocks are for professional racing and the rider assumes all risks of injury while using this product.

Settings

ability _____ spring rate _____
 terrain _____ nitrogen _____
 weight _____ hi/low comp _____
 hose _____ rebound _____
 eye to eye _____ stroke _____

AVALANCHE DOWNHILL RACING
12 DAVIDSON ROAD
COLCHESTER, CT 06415
860-537-4306
fax 860-537-8260

website: www.avalanchedownhillracing.com
 e-mail: support@avalanchedownhillracing.com